



Rural Addressing Program

The County of Minburn's rural addressing program assigns addresses to each rural property so that its location can be easily identified and found by local service and utility companies and the general public. Most importantly, however, the rural address allows the location of persons in crisis to be quickly and accurately identified by response personnel such as Police, Fire, and Ambulance in emergencies involving the threat to life, health, property or the safety of residents in the County of Minburn.

All of our rural addresses are incorporated into the County's Geographic Information System (GIS) database and shared with TELUS Communications to link to TELUS 911, 911 Dispatch and Emergency Responders.

FREQUENTLY ASKED QUESTIONS

What is it?

A standardized system which assigns an address to rural properties throughout a municipality to allow them to be quickly and easily identified by emergency response agencies (police, fire ambulance) service providers, residents and non-residents.

How are rural addresses created?

Rural addresses are based on the Township/Range Road Grid System, in many ways, a rural address resembles a city or town address, with township and range roads taking the place of streets and avenues. Similar to urban addressing, a dwelling or business is assigned an "Access Number." A typical address would be 51319 Rge Rd 134.

What happens if there are multiple dwellings on the same access?

When an access serves more than one residence on a property the access number would be followed by a letter designation. In this example a typical address would be 51319A Rge Rd 134.

What about subdivisions?

Rural addressing within subdivisions is similar to an apartment building in a city. There is one primary access to an apartment and each suite in the building has a unique identifying number. Subdivisions are numbered clockwise from the access road entry. In some subdivisions due to size and the number of primary accesses, several different addresses may exist for the same subdivision. Subdivision signage would include a large subdivision sign at the same address and individual lot number signs within the subdivision. A typical address would be 40, 51319 Rge Rd 134.

How do I get a rural address?

Rural addresses are typically assigned during the development permit process. However, if you do not have one or require a replacement sign, please contact the County office. The cost is \$50 (plus GST) in accordance to the County of Minburn's Master Rates Bylaw 1281-19.

What are the benefits of using rural addresses over a legal land description?

A legal land description will identify where a property is located on a specific quarter section whereas a rural address will pinpoint the access to the property off a road allowance.

Is the rural address the same as a mailing address?

No, they are two different addresses. Your current Canada Post mailing address will not change, so please continue using your existing mailing address to send and receive parcels and letters.

What assigns rural addresses and who will have access to my address?

Rural addressing information is assigned and maintained by the County of Minburn No. 27. Rural addresses are shared with TELUS Communications to link to TELUS 911, 911 Dispatch and Emergency Responders.

What do I do with my new rural address once I get it?

You don't need to do anything with your new rural address, other than memorize it! Your new rural address is primarily for emergency response. If you even need to call 911, you can give 911 dispatcher this address. We recommend posting your rural address near every phone in your house. Also be sure to educate your children as to what your rural address is, what it is for, and how it should be used in the event of an emergency.

Who installs the rural address?

Once the County assigns your rural address and a sign is ordered, County Operations staff will install the sign at the approach to your property when weather and time permit.

Is it mandatory?

Yes, all developed rural properties with an inhabited residence or business will require a rural address and proper signage.

[CHECK THE MAP ON THE BACK TO SEE HOW RURAL ADDRESSING WORKS...](#)

Rural Addressing Example:

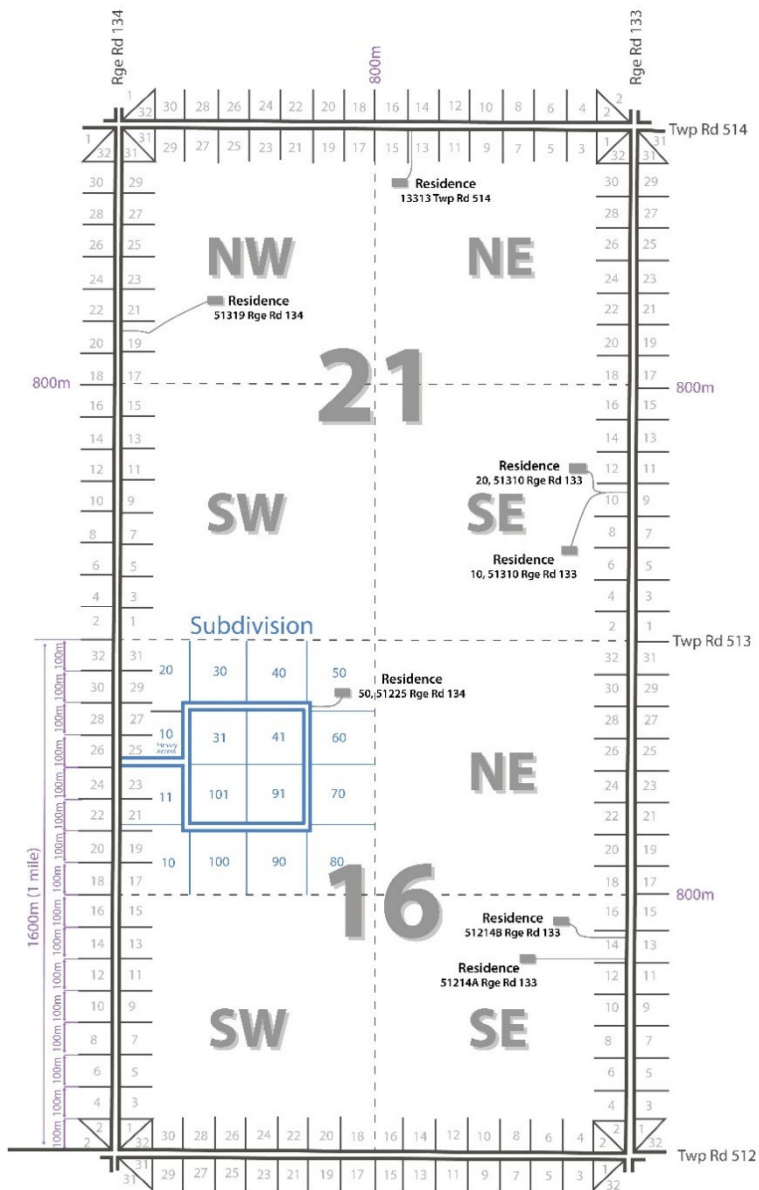

General Rules and Guidelines

- Addresses are based on access locations (approaches) along Township Roads, Range Roads, and Highways.
- Each mile of Township Road, Range Road and Highway is divided into 16 address intervals.
- Each mile of Township Road, Range Road and Highway has 32 addresses.
- Address numbers increase from South to North and from East to West.
- Odd address numbers are on the South and East sides of roads.
- Even address numbers are on the North and West sides of roads.

Standard Abbreviations:

- Rge Rd = Range Road
 - Twp Rd = Township Road
 - Hwy = Highway
- **Example: 51319 Rge Rd 134**
The access location (approach) is on Rge Rd 134. 513 is the intersecting Twp Rd number to the south. 19 is the address number on the east side of Rge Rd 134.
 - **Example: 13313 Twp Rd 514**
The access location (approach) is on Twp Rd 514. 133 is the intersecting Rge Rd number to the east. 13 is the address number on the south side of Twp Rd 514.
 - **Example: 10, 51310 Rge Rd 133 and 20, 51310 Rge Rd 133**
When two or more addresses on the same side of a road have the same access location (approach), a numeric prefix is used to distinguish among the addresses.
 - **Example: 50, 51225 Rge Rd 134**
Subdivision addresses are based on the location of the intersection of the subdivision road with a Township Road, Range Road or Highway. Subdivision lots are treated as multiple addresses having the same access location (approach).
 - **Example: 51214A Rge Rd 133 and 51214B Rge Rd 133**
When two or more access locations on the same side of a road fall within the same address interval, a letter suffix is used to distinguish among the addresses.